

# HINGE AND GUIDE RAIL

HIGOLD®  
Leading Design  
Perfect Experience

## 基础五金

无论是衣柜还是橱柜，HIGOLD基础五金都在极力帮助你实现家具使用舒适的完美解决方案。如果你正在寻求多种承重级别、出色的安装便利性、可适配的动态开合、高品质的五金产品来打造轻柔静谧的开合体验，那么HIGOLD就是你无法忽略的选项。

Whether it is a wardrobe or a cabinet, the basic hardware system of HIGOLD is trying its best to help you realize a complete solution for the comfort of furniture use. If you are looking for a variety of load-bearing levels, excellent installation convenience, optional dynamic opening and closing, and high-quality hardware products for a soft and quiet opening and closing experience, then HIGOLD is an option you can't ignore.









M2.0 / SERIES

## M2.0 SERIES

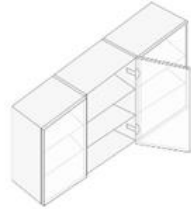

### M2.0系列固装二段力阻尼铰链

M系列铰链采用双层密封圈精密设计的特殊定制液压缸，性能表现更稳定、更突出。  
The M series hinge adopts a special customized hydraulic cylinder with double-layer sealing ring precision design, and its performance is more stable and outstanding.



特性 FEATURES	组件 COMPONENTS	配件 PARTS
- 开启角度 105°-3°		
- 铰链深度: 11.5mm	铰链螺丝	用于安装铰链的木工螺丝
- 带集成 HMOTION 阻尼	铰链杯	4x16mm
- 3 档调节	预装固定式阻尼铰链	盖帽螺母
- 使用内置式 HMOTION 阻尼，确保无噪音和反弹		

#### 型号 ART.NO. 813381-H

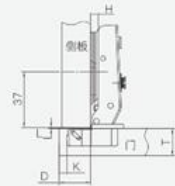

  二段力 全臂  
Two force Full Overlay



H=16+K-D

3	4	5	6	7	
0	19	20	21	22	23
2	17	18	19	20	21
4	15	16	17	18	19

#### 型号 ART.NO. 813382-H

  二段力 中臂  
Two force Half Overlay

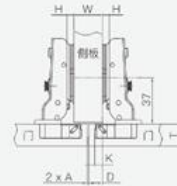

H=6+K-D

3	4	5	6	7	
0	9	10	11	12	13
2	7	8	9	10	11
4	5	6	7	8	9

#### 型号 ART.NO. 813383-H

  二段力 大号  
Two force Inset

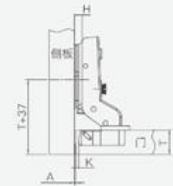

H=4+K+A

3	4	5	6	7	
0	1	0	-1	-2	-3
2	3	2	1	0	-1
4	5	4	3	2	1













## G SERIES

G系列固装铝框门一段力铰链

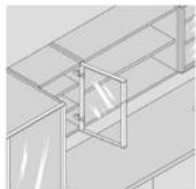

特性 FEATURES	组件 COMPONENTS	配件 PARTS
<ul style="list-style-type: none"> <li>- 开启角度 96°±3°</li> <li>- 铰链轴孔尺寸: 28mm</li> <li>- 铝型材适用宽度: 19-25mm</li> <li>- 液压缓冲阻尼</li> <li>- 三维调节</li> </ul>	固定式阻尼铰链	装饰盖板

型号 ART.NO. 813371

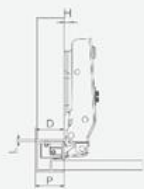

H=P-D

19	20	21	22	23
0	19	20	21	22
2	17	18	19	20
4	15	16	17	18

P= 铝型材适用宽度  
T= 铝型材适用厚度  
H= 底座高度  
L= 门板与铝框的距离距离

型号 ART.NO. 813372

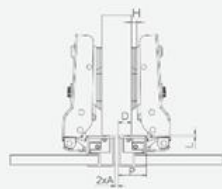

H=10+P-D

19	20	21	22	23
0	9	10	11	12
2	7	8	9	10
4	5	6	7	8

型号 ART.NO. 813373

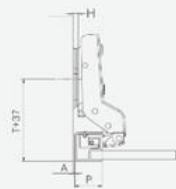

H=20+P+A

19	20	21	22	23
0	1	0	-1	-2
2	3	2	1	0
4	5	4	3	2

## G SERIES

G系列快装铝框门一段力铰链

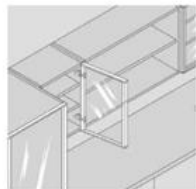

特性 FEATURES	组件 COMPONENTS	配件 PARTS
<ul style="list-style-type: none"> <li>- 开启角度 96°±3°</li> <li>- 铰链轴孔尺寸: 28mm</li> <li>- 铝型材适用宽度: 19-25mm</li> <li>- 液压缓冲阻尼</li> <li>- 三维调节</li> </ul>	铰链螺柱 铰链轴 快速式阻尼铰链	装饰盖板

型号 ART.NO. 813374



H=P-D

19	20	21	22	23
0	19	20	21	22
2	17	18	19	20
4	15	16	17	18

P= 铝型材适用宽度  
T= 铝型材适用厚度  
H= 底座高度  
L= 门板与铝框的距离距离

型号 ART.NO. 813375

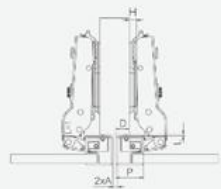

H=10+P-D

19	20	21	22	23
0	9	10	11	12
2	7	8	9	10
4	5	6	7	8

型号 ART.NO. 813376



H=20+P+A

19	20	21	22	23
0	1	0	-1	-2
2	3	2	1	0
4	5	4	3	2









## G SERIES

## G系列固装二段力阻尼铰链

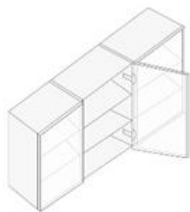
特性  
FEATURES

- 开启角度: 105°±3'
- 铰链深度: 11.5±0.1mm
- 铰链直径: 35mm
- 面板 (K) 尺寸: 3-7mm
- 门可选用板厚度: 14-21mm

组件  
COMPONENTS

铰链螺丝  
铰链杯  
固定式阻尼铰链

配件  
PARTS

缓冲器套

## 型号 ART.NO. 813017

  二段力 直弯  
Two force Full Overlay

D: 定位计算值表  
H=14+K-D

K\H	3	4	5	6	7
0	19	20	21	22	23
2	17	18	19	20	19
4	14	15	16	17	18

## 型号 ART.NO. 813018

  二段力 中弯  
Two force Half Overlay

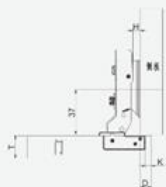
D: 定位计算值表  
H=5+K-D

K\H	3	4	5	6	7
0	1	0	-1	-2	-3
2	3	2	1	0	-1
4	5	4	3	2	1

## 型号 ART.NO. 813019

  二段力 大弯  
Two force Inset

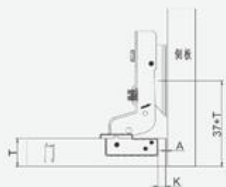
A: 安装计算值表  
H=4+K-A

K\A	3	4	5	6	7	8
0	1	0	-1	-2	-3	-4
2	3	2	1	0	-1	-2
4	5	4	3	2	1	0

## G SERIES

## G系列快装二段力阻尼铰链

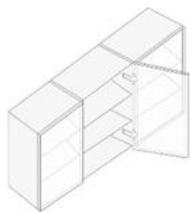
特性  
FEATURES

- 开启角度: 105°±3'
- 铰链深度: 11.5±0.1mm
- 铰链直径: 35mm
- 面板 (K) 尺寸: 3-7mm
- 门可选用板厚度: 14-21mm
- 门需附体的安装和拆卸专用工具

组件  
COMPONENTS

铰链螺丝  
铰链杯  
快装式阻尼铰链

配件  
PARTS

缓冲器套

## 型号 ART.NO. 813027

  二段力 直弯  
Two force Full Overlay

D: 定位计算值表  
H=14+K-D

K\H	3	4	5	6	7
0	19	20	21	22	23
2	17	18	19	20	19
4	14	15	16	17	18

## 型号 ART.NO. 813028

  二段力 中弯  
Two force Half Overlay

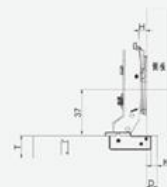
D: 定位计算值表  
H=5+K-D

K\H	3	4	5	6	7
0	1	0	-1	-2	-3
2	3	2	1	0	-1
4	5	4	3	2	1

## 型号 ART.NO. 813029

  二段力 大弯  
Two force Inset

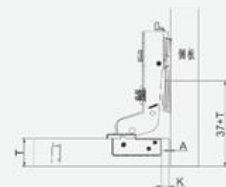
A: 安装计算值表  
H=4+K-A

K\A	3	4	5	6	7	8
0	1	0	-1	-2	-3	-4
2	3	2	1	0	-1	-2
4	5	4	3	2	1	0



## G SERIES

### G系列304不锈钢铰链

三维调节轻松调正柜门，大范围深度调节，有利于开孔纠错，快速调整门歪、门缝大等问题，提高安装效率。

Quickly adjust the door askew, large door crack and other problems, improve the installation efficiency.

- ① 左右调节    ② 前后调节    ③ 上下调节  
+3mm/0.5mm    ±4mm    ±2mm







## G SERIES SS HINGE

### G系列天地铰链

缓冲速度调节105°大广角开启，采用隐藏式对称设计，柜体内部因此变得更整洁美观，集精湛技术与现代美学于一体功能卓越，内置阻尼缓冲系统，阻尼慢关，轻柔静音，美好的生活从现在开始。

With the symmetrical design of hidden cabinet, the interior of Cabinet becomes more clean and beautiful, combining superb technology and modern aesthetics, with excellent function, built-in damping buffer system, slow damping off, soft mute, a better life from now on.

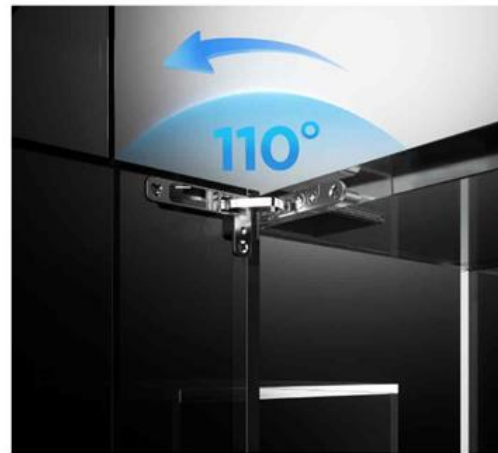



## G SERIES

G系列天地铰链 (轻型)



型号 ART. NO.	特性 FEATURES	配件 PARTS
<b>813271</b> 轻型 - 承重 25kg	<ul style="list-style-type: none"> <li>- 产品材质: 锌合金</li> <li>- 铰杯深度: 轻型 16mm</li> <li>- 开合次数: 50000 次以上</li> <li>- 带盖或 HMOTION 阻尼</li> <li>- 3 维调节</li> </ul>	安装说明书 沉头螺丝 4x12 6 颗

PRODUCT ADJUSTMENT DIAGRAM | 产品调节示意图

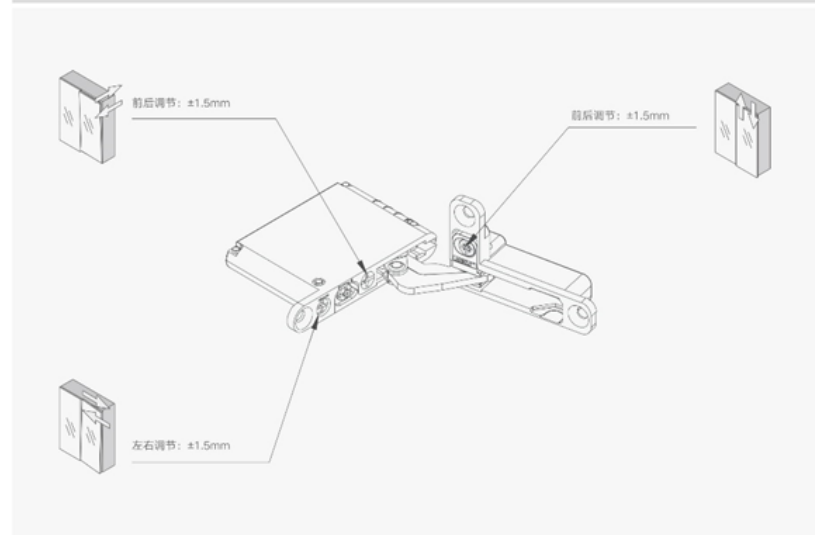

CABINET DIAGRAM | 柜体示意图

DOOR PANEL & CABINET PARAMETERS | 门板与柜体参数

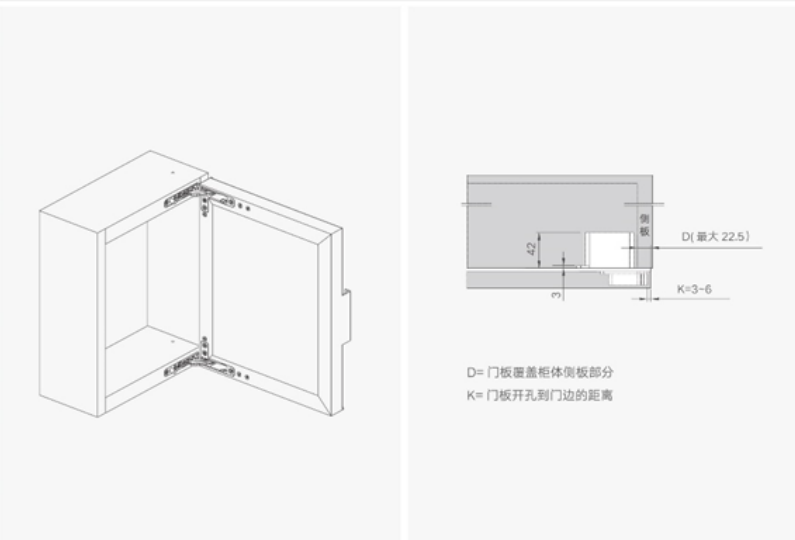

INSTALLATION SIZE | 安装尺寸 (A=B)

1. 柜体开孔尺寸图  
单位: mm

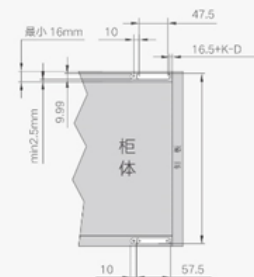

2. 木门和铝门框开孔尺寸图  
单位: mm

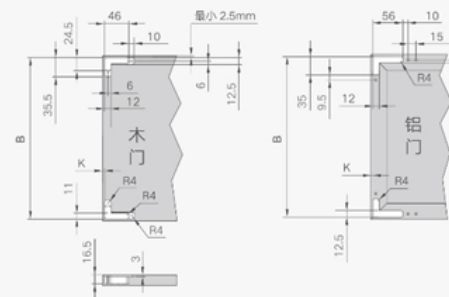





N2.0 / SERIES

## N2.0 SERIES

### N2.0固装一段力阻尼铰链

冷艳的外观下，是不容小觑的实力隐藏。不争不抢，不打扰，N2.0系列铰链，向世界诠释什么才是真正有态度的生活。  
Physically attractive, indispensable quality. Buddha-like, N2.0-Series Hinges. A different interpretation on the truth of contented living.

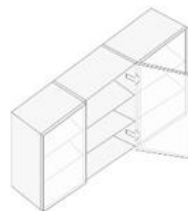

特性 FEATURES	组件 COMPONENTS	配件 PARTS
<ul style="list-style-type: none"> <li>- 开启角度 105±3°</li> <li>- 安装深度: 11.5±0.1mm</li> <li>- 带蒙皮+HMOTION 密封</li> <li>- 3 档调节</li> <li>- 使用片盖式 HMOTION 密封, 确保无尘埃和异响</li> </ul>	<ul style="list-style-type: none"> <li>铰链杆</li> <li>固定式阻尼铰链</li> </ul>	<ul style="list-style-type: none"> <li>自吸蝶盖</li> </ul>

型号 ART NO 813241-H

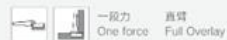

3	4	5	6	7	
0	17	18	19	20	21
2	15	16	17	18	19

型号 ART NO 813242-H



3	4	5	6	7	
0	8	9	10	11	12
2	6	7	8	9	10

型号 ART NO 813243-H



3	4	5	6	7	
0	1	0	-1	-2	-3
2	3	2	1	0	-1







## G SERIES

G系列固装二段力小角度阻尼铰链

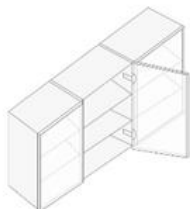

特性 FEATURES	组件 COMPONENTS	配件 PARTS
<ul style="list-style-type: none"> <li>- 开启角度: 105±3°</li> <li>- 铰链深度: 11.5±0.1mm</li> <li>- 铰链直径: 35mm</li> <li>- 翼板 (K) 尺寸: 3-7mm</li> <li>- 门可选用板厚度: 14-21mm</li> </ul>	<ul style="list-style-type: none"> <li>铰链主体</li> <li>翼板</li> <li>固定式阻尼铰链</li> </ul>	翼板衬套

型号 ART.NO. 813421

D: 定位计算值表  
H= 14K-D

2	4	3	4	5	6	7
0	19	20	21	22	23	
2	17	18	19	20	21	
4	15	16	17	18	19	

型号 ART.NO. 813422

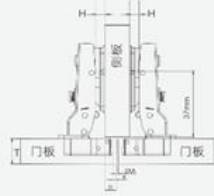
D: 定位计算值表  
H= 4K-D

2	4	3	4	5	6	7
0	8	9	10	11	12	
2	6	7	8	9	10	
4	4	5	6	7	8	

型号 ART.NO. 813423

A: 调整计算值表  
H= K+A

2	4	3	4	5	6	7
0	1	0	-1	-2	-3	
2	3	2	1	0	-1	
4	5	4	3	2	1	

## G SERIES

G系列快装二段力小角度阻尼铰链

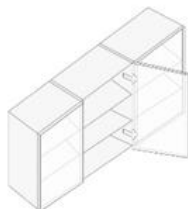

特性 FEATURES	组件 COMPONENTS	配件 PARTS
<ul style="list-style-type: none"> <li>- 开启角度: 105±3°</li> <li>- 铰链深度: 11.5±0.1mm</li> <li>- 铰链直径: 35mm</li> <li>- 翼板 (K) 尺寸: 3-7mm</li> <li>- 门可选用板厚度: 14-21mm</li> <li>- 门铰链体的结束和预加工工具</li> </ul>	<ul style="list-style-type: none"> <li>铰链主体</li> <li>铰链杆</li> <li>快速式阻尼铰链</li> </ul>	翼板衬套

型号 ART.NO. 813424

D: 定位计算值表  
H= 14K-D

2	4	3	4	5	6	7
0	19	20	21	22	23	
2	17	18	19	20	21	
4	15	16	17	18	19	

型号 ART.NO. 813425

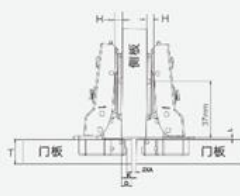
D: 定位计算值表  
H= 4K-D

2	4	3	4	5	6	7
0	8	9	10	11	12	
2	6	7	8	9	10	
4	4	5	6	7	8	

型号 ART.NO. 813426

A: 调整计算值表  
H= K+A

2	4	3	4	5	6	7
0	1	0	-1	-2	-3	
2	3	2	1	0	-1	
4	5	4	3	2	1	





## G / SERIES

### G45° SERIES

#### G系列45° 快装阻尼铰链

G系列45° 铰链巧妙地为五角柜提供解决方案，满足个性化需求的橱柜，扩大橱柜收纳空间的同时也让转角位置台面更大，提升橱柜整理利用率。

G45° hinge cleverly for the Pentagon cabinet to provide solutions, to meet the needs of personalized cabinets, cabinet storage space to expand the corner position of the table is larger, improve the use of cabinet finishing.

型号 ARTNO	特性 FEATURES	组件 COMPONENTS	配件 PARTS
813143	<ul style="list-style-type: none"> <li>- 产品材质: 冷轧钢</li> <li>- 开启角度: 110°</li> <li>- 铰链深度: 12mm</li> <li>- 开合次数: 50000 次以上</li> <li>- 带集成 HMACTION 阻尼</li> <li>- 3 级调节</li> </ul>	<ul style="list-style-type: none"> <li>铰链底座</li> <li>铰链杯</li> <li>底座快装碗尾盖铰链</li> </ul>	需于安装铰链的木工或柜架师傅

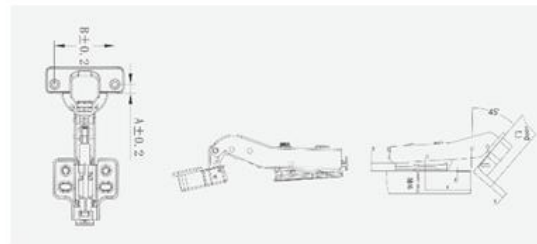

	4	5	6	7	
0	37	3	36	25	34
2	37	1	35	25	34
4	37	-1	35	25	34

备注: T45 铰链以标配 H=0/2/4 的 2 孔底座

H 为铰链高  
U 为安装位  
X 为铰链 L 型板的 L 孔位置  
A 为 L 型板 L 型板的垂直距离  
T 为 L 型厚度









双门连动开门  
需搭配165°铰链一起使用



G / SERIES

## G135° SERIES

卧室常见的转角位置可使用L型铰链，柜门搭配上135°铰链，解决柜体空间利用以及柜门难打开的问题，使转角空间完整展现眼前。  
The common corner position of the bedroom can use the L-shaped door, and the cabinet door is equipped with a 135° hinge to solve the problem of cabinet space utilization and the difficulty of opening the cabinet door, so that the corner space can be fully displayed.

### G系列135° 滑入式阻尼铰链

型号 ARTNO.	特性 FEATURES	组件 COMPONENTS	配件 PARTS
813134	<ul style="list-style-type: none"> <li>- 产国材质: 冷轧钢</li> <li>- 开始角度: 100°</li> <li>- 铰链深度: 12mm</li> <li>- 开合次数: 50000 次以上</li> <li>- 带集成 HIMATION 阻尼</li> <li>- 3 档调节</li> </ul>	<ul style="list-style-type: none"> <li>铰链螺母</li> <li>铰链杯</li> <li>滑入快装式阻尼铰链</li> </ul>	用于安装铰链的木工基材 安装所需

### G系列135° 快装式阻尼铰链

型号 ARTNO.	特性 FEATURES	组件 COMPONENTS	配件 PARTS
813135	<ul style="list-style-type: none"> <li>- 产国材质: 冷轧钢</li> <li>- 开始角度: 100°</li> <li>- 铰链深度: 12mm</li> <li>- 开合次数: 50000 次以上</li> <li>- 带集成 HIMATION 阻尼</li> <li>- 3 档调节</li> </ul>	<ul style="list-style-type: none"> <li>铰链螺母</li> <li>铰链杯</li> <li>滑入快装式阻尼铰链</li> </ul>	用于安装铰链的木工基材 安装所需

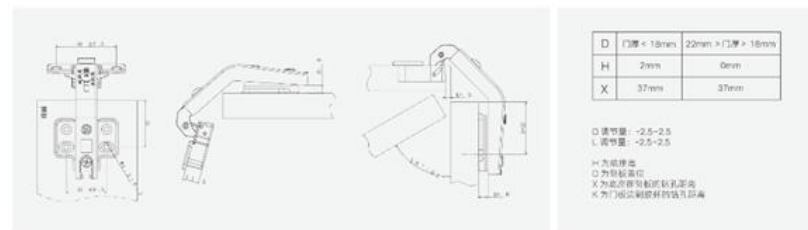



G / SERIES

## G165° SERIES

### G系列165°快装阻尼铰链

特殊的开合角度，让衣柜、橱柜的转角空间不再尴尬，更大的开门角度，带来更宽敞的取物空间，让生活更加便利。

Used on specific opening angles, make full use of the corner space in wardrobe and kitchen cabinets; Larger opening angle, delivering more spacious space for movements and more convenient experience.

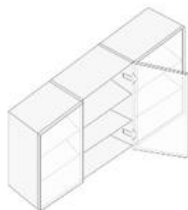

#### 特性 FEATURES

- 开合角度: 165°/4"
- 关门角度: 87°/42"
- 门板连接厚度: 1.4mm-26mm
- 距柜体厚度: 1.5mm/ + 1.5mm
- 开合寿命: 50000次以上
- 材质: 1.8mm-3.0厚钢材
- 承重测试: 48h-中档承重测试, 8级以上
- 3维调节
- 内置式阻尼, 确保关门柔和安静

#### 组件 COMPONENTS

- 塑料键轴
- 制铰杆
- 固定式柜体铰链

#### 型号 ART NO 813357



一阻尼 直臂  
One force Full Overlay

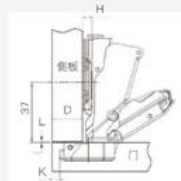

H=14-K-D

3	4	5	6	7	
10	11	16	19	20	21
2	15	10	17	18	19
4	13	14	15	16	17

#### 型号 ART NO 813358



一阻尼 中弯  
One force Half Overlay

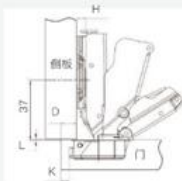

H=4-K-D

3	4	5	6	7	
10	7	8	9	10	11
2	5	6	7	8	9
4	3	4	5	6	7

#### 型号 ART NO 813359



一阻尼 大弯  
One force Inset

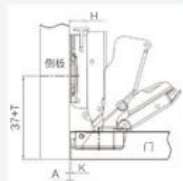

H\*K\*A

3	4	5	6	7	
2	-1	-2	-3	-4	-5
4	1	0	-1	-2	-3



#### 双门大角度对开

适合橱柜、衣柜转角



#### 双门连动开门

需搭配135°铰链一起使用





## N SERIES DRAWER

### N系列超薄反弹骑马抽

纤影随行，巧享开合。尽显一体之美，点缀一隅空间。  
洞悉空间法则，于方寸间彰显玲珑美学。

All show a body beauty, adorn a space. The overall lighter and delicate.  
Insight into space law, reveal aesthetics.



## N SERIES DRAWER

N系列超薄反弹骑马抽 (86mm)



型号 (磨砂灰) ART. NO.	标称长度 NL	特性 FEATURES
816806	270mm	
816807	350mm	- 无安装面积技术 - 内嵌式设计
816808	400mm	- 三节同步悬浮轨道技术 - 儿童锁扣
816809	450mm	- N系列骑马抽承重 (40KG) - 超长寿命 (50000 万次开合)
816810	500mm	- 进口户外级涂层

Sheet Cutting Dimension | 裁切尺寸 (mm)

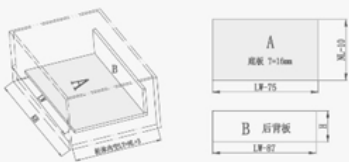

后背板裁板尺寸

产品高度	后导轨高度 H
86mm	86mm
118mm	118mm
167mm	167mm
199mm	199mm

COMPONENTS | 组件

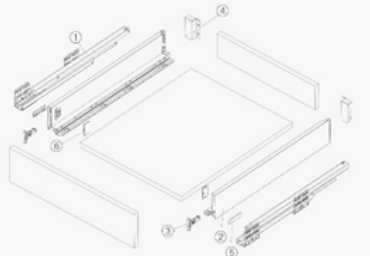

- ① 导轨 ② 抽帮 ③ 前接码 ④ 后接码 ⑤ 铭牌 ⑥ 圆盖

KB 箱体宽  
LW 箱体净  
NL 标称长

SLIDE RAIL INSTALLATION DIMENSION | 柜体滑轨安装尺寸

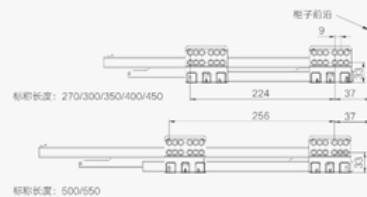

SLIDE RAIL INSTALLATION DIMENSION | 柜体滑轨安装尺寸



DRAWER INSTALLATION | 抽屉安装

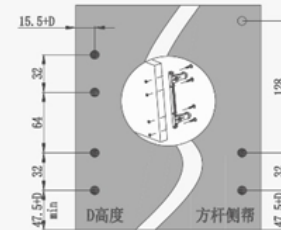
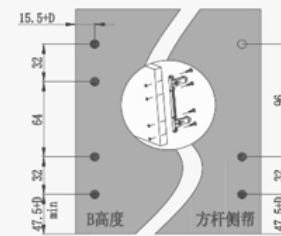
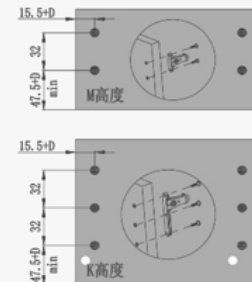
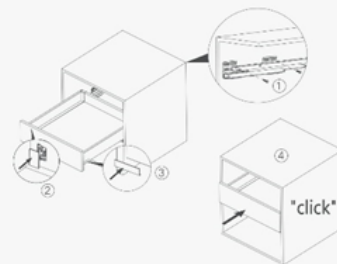

- 前接码安装孔 方形拉杆面板开孔尺寸
- 加高杆安装孔 面板尺寸自行裁切









277

## N SERIES DRAWER

### N系列薄款骑马抽

纤影随行，巧享开合。尽显一体之美，点缀一隅空间。  
侧邦厚度仅13mm，整体更加轻盈精致。洞悉空间法则，于方寸间彰显玲珑美学。  
All show a body beauty, adorn a space. Side bond 13 mm thickness, and the overall lighter and delicate. Insight into space law, reveal aesthetics.





更稳固，40kg持续承重，下盘度令人满意



二档调节，整齐划一，内置高度 & 左右调节灵活可调，保证家具摆放整齐划一

## N SERIES DRAWER

N系列薄款骑马抽 (86mm)



型号 (磨砂灰) ART. NO.	标称长度 NL	特性 FEATURES
816606	270mm	
816607	350mm	- 无安装面积技术 - 内嵌式面板设计
816608	400mm	- 三节同步悬浮轨道技术 - 儿童锁扣
816609	450mm	- N系列骑马滑轨承重 (40KG) - 超长寿命 (50000 万次开合)
816610	500mm	- 进口户外级涂层

Sheet Cutting Dimension | 裁切尺寸 (mm)

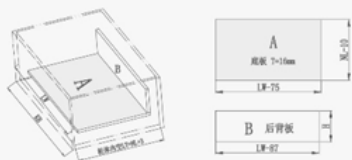

后背板裁板尺寸

产品高度	后导轨高度 H
86mm	86mm
118mm	118mm
167mm	167mm
199mm	199mm

KB 箱体宽  
LW 箱体净  
NL 标称长

COMPONENTS | 组件

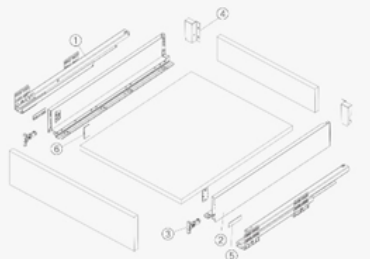

- ① 导轨 ② 抽帮 ③ 前接码 ④ 后接码 ⑤ 铭牌 ⑥ 圆盖



SLIDE RAIL INSTALLATION DIMENSION | 柜体滑轨安装尺寸

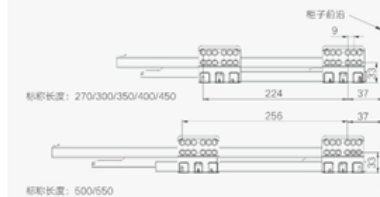

SLIDE RAIL INSTALLATION DIMENSION | 柜体滑轨安装尺寸



DRAWER INSTALLATION | 抽屉安装

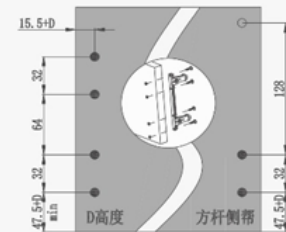
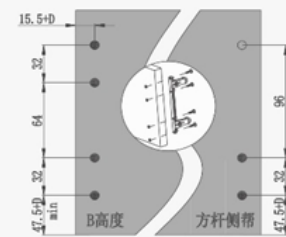
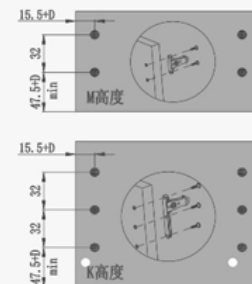
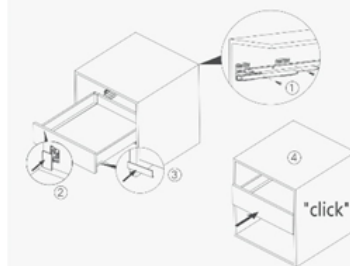

- 前接码安装孔 方形拉杆面板开孔尺寸
- 加高杆安装孔 面板尺寸自行裁切



## N SERIES DRAWER

N系列薄款骑马抽 (167mm)



型号 (磨砂灰) ART. NO.	标称长度 NL	特性 FEATURES
816626	270mm	
816627	350mm	- 无安装面积技术 - 内嵌式前切设计
816628	400mm	- 三节同步悬浮轨道技术 - 儿童锁扣
816629	450mm	- N系列骑马抽承重 (40KG) - 超长寿命 (50000 万次开合) - 进口户外级滚轮
816630	500mm	

Sheet Cutting Dimension | 裁切尺寸 (mm)

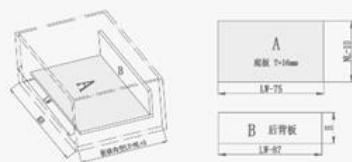

后背板裁板尺寸

产品高度	后背板高度 H
86mm	86mm
118mm	118mm
167mm	167mm
199mm	199mm

KB 箱体宽  
LW 箱体净  
NL 标称长

COMPONENTS | 组件

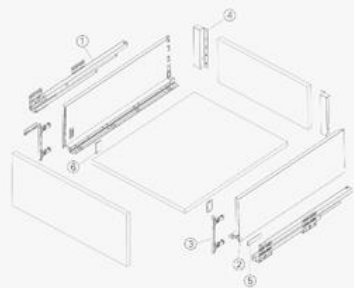

- ① 导轨 ② 抽杆 ③ 前接码 ④ 后接码 ⑤ 铁脚 ⑥ 黄盖

SLIDE RAIL INSTALLATION DIMENSION | 柜体滑轨安装尺寸

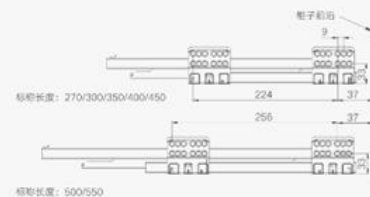

SLIDE RAIL INSTALLATION DIMENSION | 柜体滑轨安装尺寸

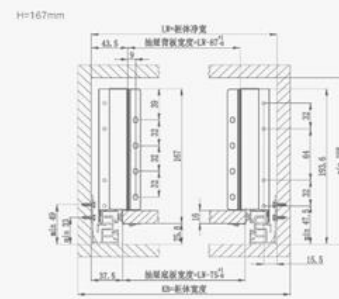

DRAWER INSTALLATION | 抽屉安装

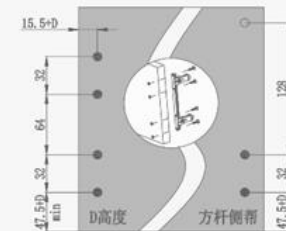
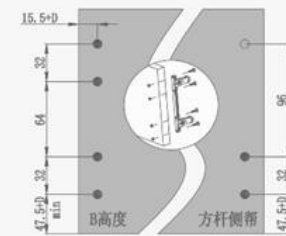
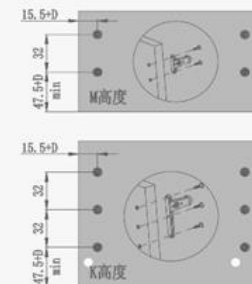
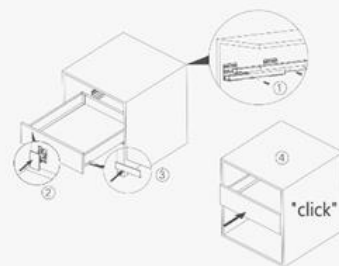

- 前接码安装孔 方形拉杆面板开孔尺寸
- 加黄杆安装孔 面板尺寸自行裁切



# G SERIES

## G系列薄款骑马抽

隐藏式阻尼，防尘轨道自动系统，六维空间同步珠架，抽拉全程顺滑，12MM薄边精致设计，45KG承重力，内外一体不拼接，采用优质钢材，精密冲压，结构坚固耐用，有效利用空间，增强存储性能。

HIGOLD drawer system, 12MM thin edge exquisite design, 45KG bearing capacity, internal and external integration without splicing, high-quality steel, precision stamping, strong and durable structure, efficient use of space, and enhanced storage performance.





# G SERIES DRAWER

G系列薄款骑马抽 (167mm)



■ 铁灰

型号 (铁灰) ART. NO.	型号 (丝光白) ART. NO.	标称长度 NL	特性 FEATURES
816026	816021	270mm	
816027	816022	350mm	- 无级变速阻尼技术 - 内置式阻尼设计
816028	816023	400mm	- 三节同步悬浮轨道技术
816029	816024	450mm	- 儿童锁扣 - G系列骑马阻尼承重 (35KG) - 超长寿命 (50000万次开合)
816030	816025	500mm	- 进口户外级滑轨
816041	-	550mm	

Sheet Cutting Dimension | 裁切尺寸 (mm)

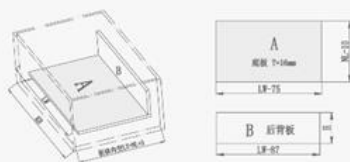

后背板裁板尺寸

产品厚度	后背板高度 H
84mm	68mm
116mm	100mm
167mm	151mm
199mm	183mm

KB 箱体宽  
LW 箱体净  
NL 标称长

COMPONENTS | 组件

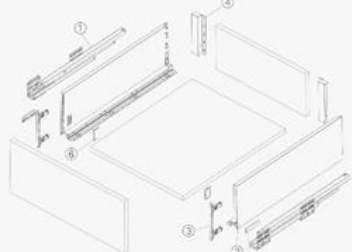

- ① 导轨 ② 抽帮 ③ 前接码 ④ 后接码 ⑤ 铁脚 ⑥ 黄盖

SLIDE RAIL INSTALLATION DIMENSION | 柜体滑轨安装尺寸

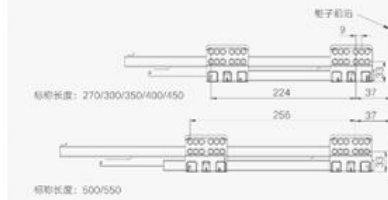

SLIDE RAIL INSTALLATION DIMENSION | 柜体滑轨安装尺寸

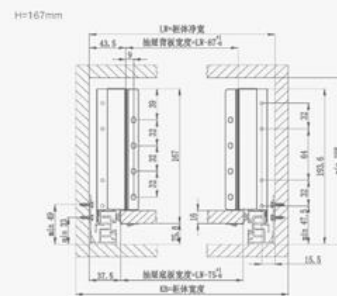

DRAWER INSTALLATION | 抽屉安装

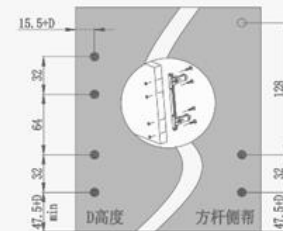
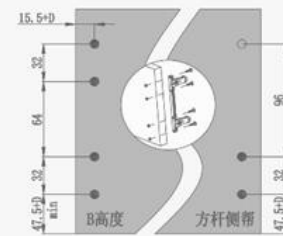
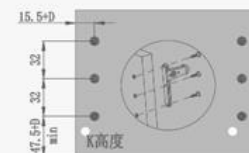
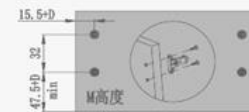
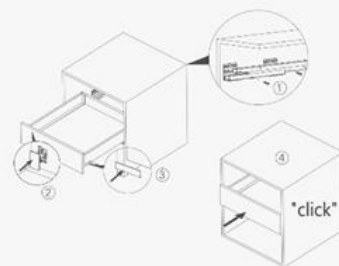

- 原接码安装孔 方形拉杆面板开孔尺寸
- 加高杆安装孔 面板尺寸自行裁切



# G SERIES DRAWER

G系列薄款骑马抽 (199mm)



型号 (铁灰) ART. NO.	型号 (丝光白) ART. NO.	标称长度 NL	特性 FEATURES
816036	816031	270mm	
816037	816032	350mm	- 无安装面积技术 - 内嵌式面切设计
816038	816033	400mm	- 三节同步悬浮轨道技术 - 儿童锁扣
816039	816034	450mm	- G系列骑马滑轨承重 (35KG) - 超长寿命 (50000万次开合) - 进口户外级滚轮
816040	816035	500mm	

Sheet Cutting Dimension | 裁切尺寸 (mm)

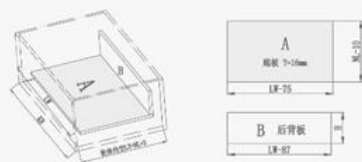

后背板裁板尺寸

产品高度	后背板高度 H
84mm	69mm
116mm	100mm
167mm	151mm
199mm	183mm

KB 箱体宽  
LW 箱体净  
NL 标称长

COMPONENTS | 组件

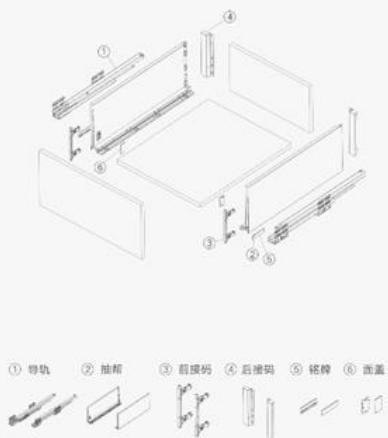

- ① 导轨
- ② 抽箱
- ③ 前堵码
- ④ 后堵码
- ⑤ 铭牌
- ⑥ 面板

SLIDE RAIL INSTALLATION DIMENSION | 柜体滑轨安装尺寸

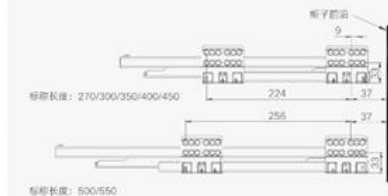

SLIDE RAIL INSTALLATION DIMENSION | 柜体滑轨安装尺寸

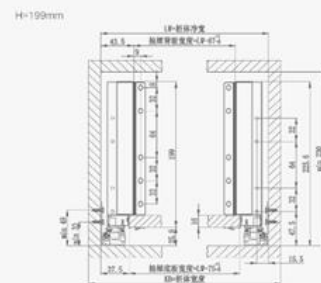

DRAWER INSTALLATION | 抽屉安装

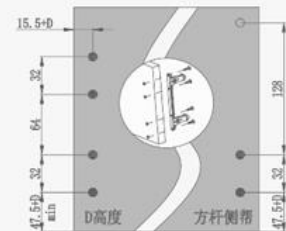
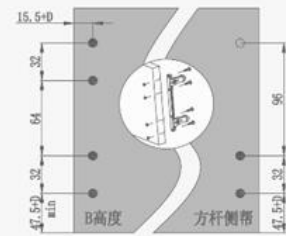
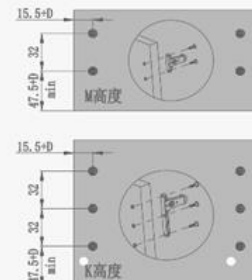
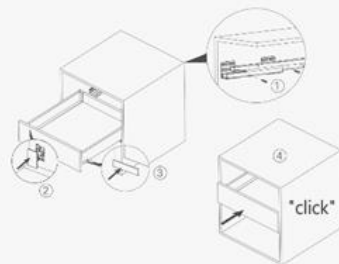

- 前堵码安装孔 方形拉杆面板开孔尺寸
- 加高杆安装孔 面板尺寸自行裁切





# G SERIES DRAWER

G系列薄款玻璃骑马抽 (199mm)



型号 ART. NO.	标称长度 NL	特性 FEATURES
814066	450mm	<ul style="list-style-type: none"> <li>- 抽屉式, 全拉式带阻尼静音功能</li> <li>- 全封防尘结构, 防尘防潮</li> <li>- HSERVETTO INSIDE 保证滑动流畅, 终生使用</li> <li>- 需安装专用工具</li> <li>- 2 维安装导轨</li> <li>- 使用内置式 H-MOTION 阻尼, 确保关闭柔和安静</li> </ul>

Sheet Cutting Dimension | 裁切尺寸 (mm)



后背板裁板尺寸

产品高度	后背板高度 H
84mm	68mm
116mm	100mm
167mm	151mm
199mm	183mm

KB 前体宽  
LW 前体净  
NL 标称长

COMPONENTS | 组件

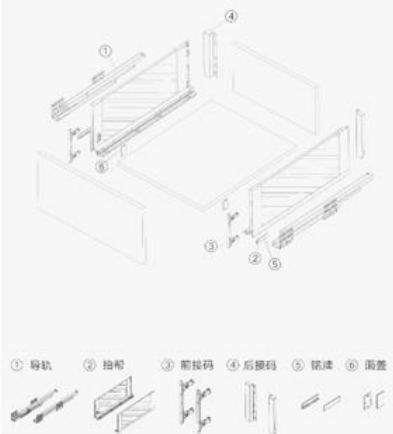

SLIDE RAIL INSTALLATION DIMENSION | 柜体滑轨安装尺寸

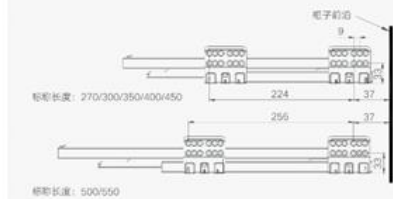

SLIDE RAIL INSTALLATION DIMENSION | 柜体滑轨安装尺寸

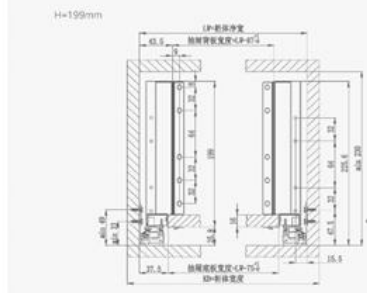

DRAWER INSTALLATION | 抽屉安装

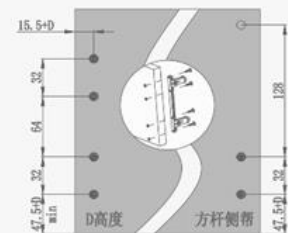
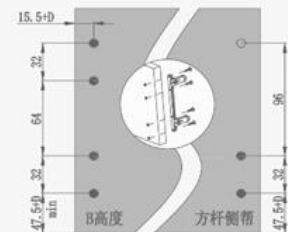
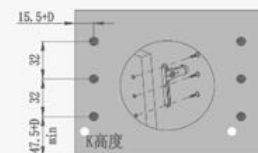
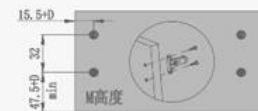
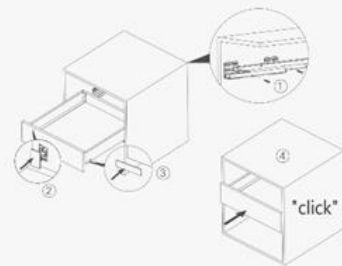

- 柜体预安装孔, 方形材料面板开孔尺寸
- 加高杆安装孔, 面板尺寸自行裁切

# G SERIES DRAWER

G系列玻璃高抽



型号 ART. NO.	标称长度 NL	特性 FEATURES
B14045	350mm	- 暗藏式, 全拉式带阻尼静音功能
B14046	400mm	- 全新百变抽层, 配磨砂玻璃 - HISERVETTO INSIDE 保证滑道流畅, 终生免用
B14047	450mm	- 软排程 雪山白 - 面板安装无需工具 - 2道复新调节
B14048	500mm	- 使用内置式 HIMOTION 阻尼, 请保证安装位置

Sheet Cutting Dimension | 裁切尺寸 (mm)



后背板裁板尺寸

产品高度	后背板高度 H
84mm	68mm
116mm	100mm
147mm	131mm
179mm	163mm

KB 箱体宽  
LW 箱体净  
NL 标称长

COMPONENTS | 组件

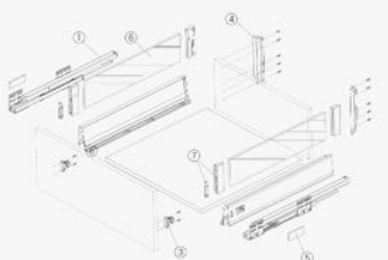

- ① 导轨
- ② 抽箱
- ③ 前接码
- ④ 后接码
- ⑤ 插销
- ⑥ 玻璃
- ⑦ 玻璃固定件

SLIDE RAIL INSTALLATION DIMENSION | 柜体滑轨安装尺寸

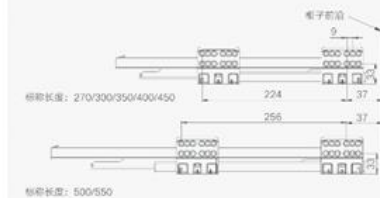

SLIDE RAIL INSTALLATION DIMENSION | 柜体滑轨安装尺寸

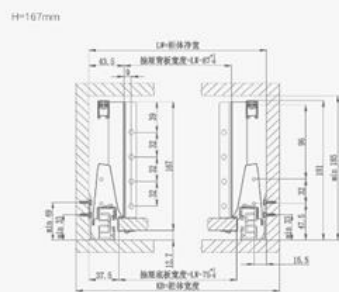

DRAWER INSTALLATION | 抽屉安装

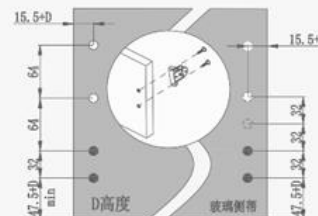
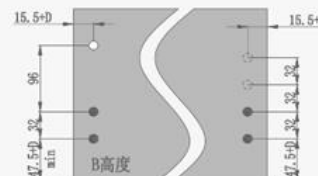
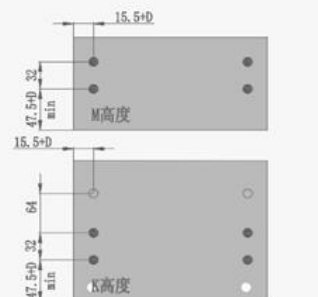
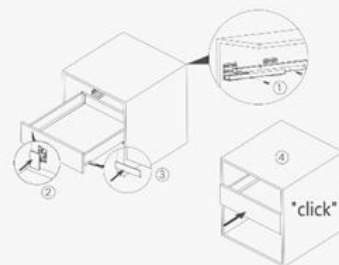

- 前接码安装孔, 方形拉杆面板开孔尺寸
- 加高杆安装孔, 面板尺寸自行裁切



# G SERIES DRAWER

G系列玻璃高抽



型号 ART. NO.	标称长度 NL	特性 FEATURES
B14052	350mm	- 碟碟式, 全封闭式带阻尼静音功能 - H-SERVETTO INSIDE 保证有助滑轨, 终生受用 - 防撞程 避砂尖
B14053	400mm	- 动态负载 30kg - 面板安装无需工具 - 2 为更舒适设计
B14054	450mm	- 使用内嵌式 H-MOTION 阻尼, 确保关闭柔和安静
B14055	500mm	

Sheet Cutting Dimension | 裁切尺寸 (mm)

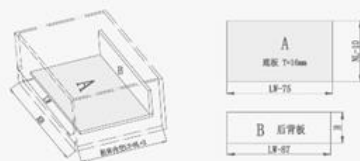

后背板裁板尺寸

产品高度	后背板高度 H
84mm	68mm
116mm	100mm
167mm	151mm
199mm	183mm

KB 箱体宽  
LW 箱体净  
NL 标称长

COMPONENTS | 组件

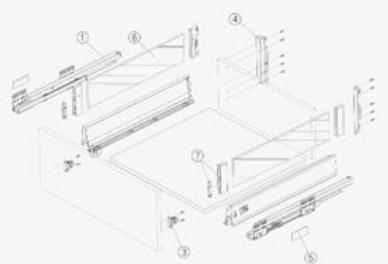

- ① 导轨
- ② 抽箱
- ③ 前接码
- ④ 后接码
- ⑤ 铁脚
- ⑥ 玻璃
- ⑦ 玻璃固定件

SLIDE RAIL INSTALLATION DIMENSION | 柜体滑轨安装尺寸

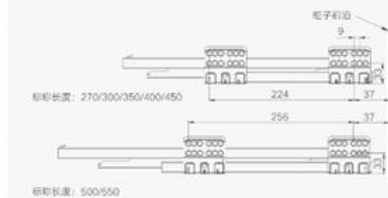

SLIDE RAIL INSTALLATION DIMENSION | 柜体滑轨安装尺寸

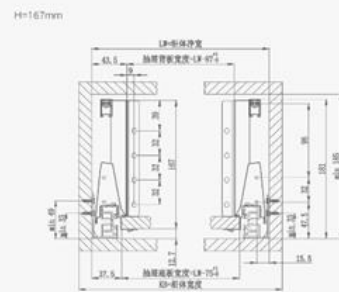

DRAWER INSTALLATION | 抽屉安装

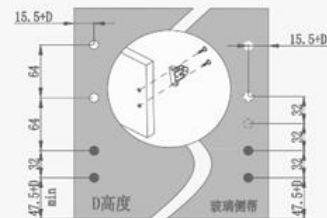
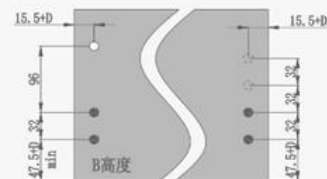
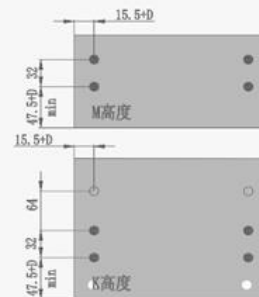
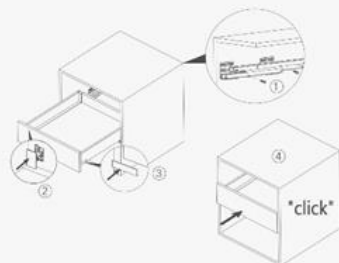

- 前槽码安装孔, 方形拉杆面板开孔尺寸
- 加高杆安装孔, 面板尺寸自行裁切

# G SERIES DRAWER

G系列豪华骑马抽 - 低抽



型号 (雪山白) ART. NO.	标称长度 NL	特性 FEATURES
814001	270mm	
814002	300mm	- 粘碟式、全位式伸阻静音功能
814003	350mm	- HISERVETTO INSIDE 保证滑动流畅, 终生使用
814004	400mm	- 钢挂杆 雪山白
814005	450mm	- 动态负载 30kg
814006	500mm	- 滑轨安装无需工具
		- 2 级高度调节
		- 使用内置式 HISERVETTO 阻粘, 确保关闭柔和安静

Sheet Cutting Dimension | 裁切尺寸 (mm)

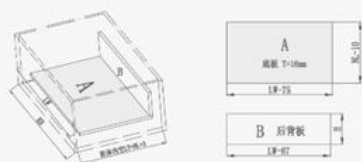

后背板裁板尺寸

产品高度	后背板高度 H
84mm	68mm
116mm	100mm
167mm	151mm
199mm	183mm

KB 箱体宽  
LV 箱体净  
NL 标称长

COMPONENTS | 组件

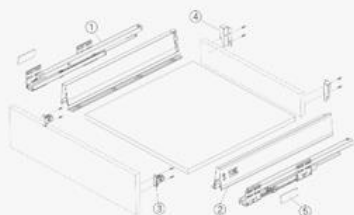

- ① 导轨 ② 抽屉 ③ 前接码 ④ 后接码 ⑤ 盖盖



SLIDE RAIL INSTALLATION DIMENSION | 柜体滑轨安装尺寸

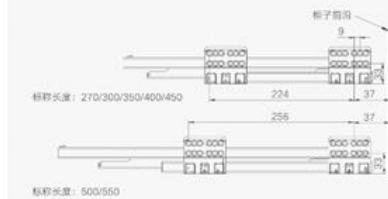

SLIDE RAIL INSTALLATION DIMENSION | 柜体滑轨安装尺寸

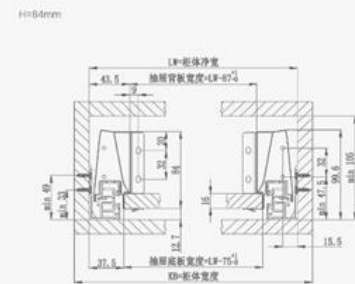

DRAWER INSTALLATION | 抽屉安装

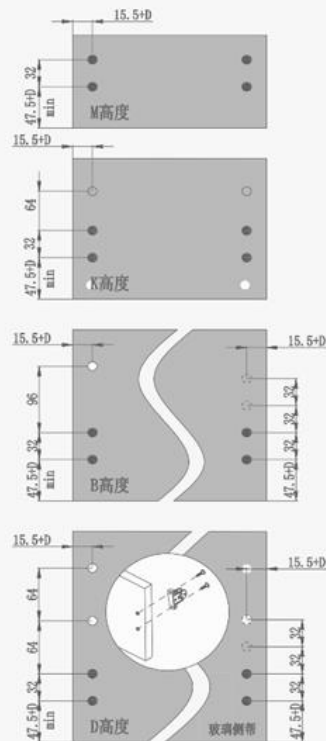
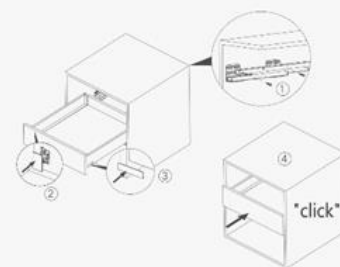

- 前接码安装孔, 方形拉杆盖板开孔尺寸
- 加高杆安装孔, 盖板尺寸自行裁切

# G SERIES DRAWER

G系列豪华骑马抽 - 低抽



型号 (磨砂灰) ART. NO.	标称长度 NL	特性 FEATURES
814008	270mm	
814010	300mm	- 基础式, 全位式阻尼静音功能 - HISERVETTO INSIDE 保证滑动流畅, 终生免用
814011	350mm	- 钢挂杆 磨砂灰 - 动态负载 30kg
814012	400mm	- 需安装专用工具
814013	450mm	- 使用内置式 HISERVETTO 阻尼, 确保关闭柔和安静
814014	500mm	

Sheet Cutting Dimension | 裁切尺寸 (mm)



后背板裁板尺寸

产品高度	后背板高度 H
84mm	68mm
76mm	100mm
70mm	76mm
79mm	73mm

KB 箱体宽  
LW 箱体净  
NL 标称长

COMPONENTS | 组件

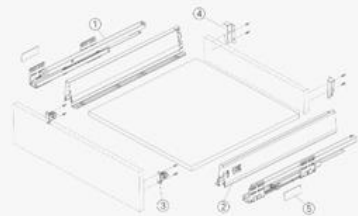

- ① 导轨 ② 抽杆 ③ 前接码 ④ 后接码 ⑤ 盖盖



SLIDE RAIL INSTALLATION DIMENSION | 柜体滑轨安装尺寸

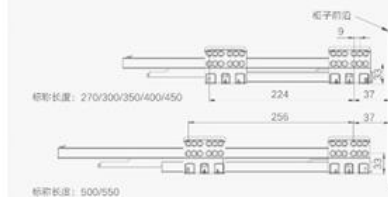

SLIDE RAIL INSTALLATION DIMENSION | 柜体滑轨安装尺寸

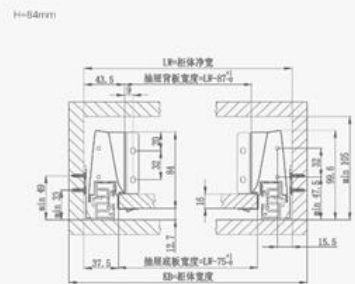

DRAWER INSTALLATION | 抽屉安装

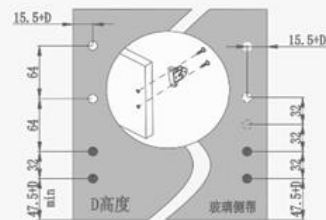
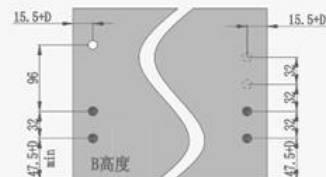
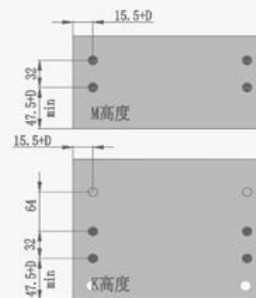
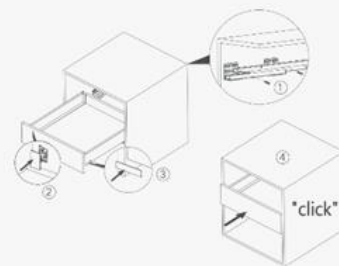

- 前接码安装孔, 方形拉杆面板开孔尺寸
- 加高杆安装孔, 面板尺寸自行裁切









# G SERIES DRAWER

G系列豪华骑马抽 - 方形高抽



型号 (磨砂灰) ART. NO.	标称长度 NL	特性 FEATURES
814251	350mm	- 隐藏式, 全拉式带阻尼静音功能
814252	400mm	- HISERVETTO INSIDE 保证滑动流畅, 终生受用 - 动态负载 30kg - 面板安装无需工具
814253	450mm	- 2 种安装图示 - 使用内置式 HISERVETTO 阻尼, 确保关闭柔和安静
814254	500mm	

Sheet Cutting Dimension | 裁切尺寸 (mm)

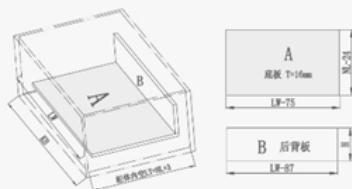

后背板裁板尺寸

产品高度	后背板高度 H
84mm	84mm
135mm	135mm
167mm	167mm
199mm	199mm

KB 箱体宽  
LW 箱体净  
NL 标称长

COMPONENTS | 组件

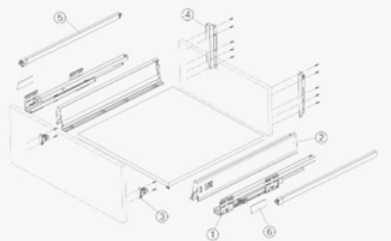

① 导轨 ② 滚轮 ③ 前接码 ④ 后接码 ⑤ 拉杆 ⑥ 面盖



SLIDE RAIL INSTALLATION DIMENSION | 柜体滑轨安装尺寸

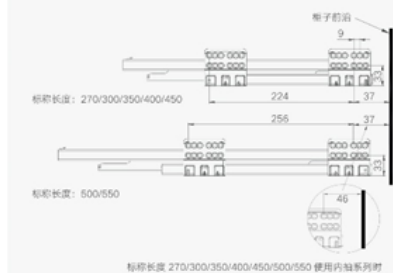

SLIDE RAIL INSTALLATION DIMENSION | 柜体滑轨安装尺寸

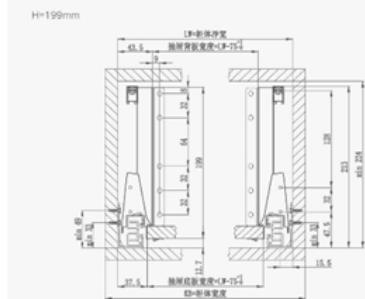

DRAWER INSTALLATION | 抽屉安装

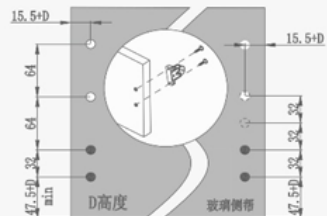
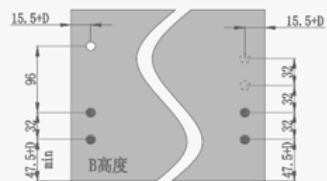
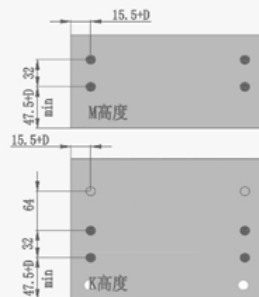
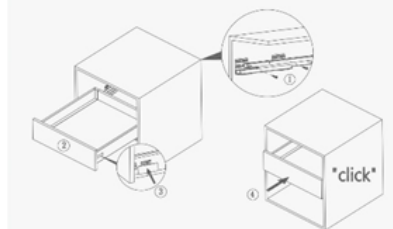

- 箱接码安装孔 玻璃抽面板开孔尺寸
- 加高杆安装孔 面板尺寸自行裁切
- 玻璃夹安装孔











# SLIDE SERIES

## 导轨·系列

对卓越的执着追求，促使我们时刻保持对产品精益求精的态度。  
导轨精致的细节、精准的运动系统都是精心灌注的产物，专为高端设计而生。  
The persistent pursuit of excellence motivates us to maintain an attitude of excellence in products at all times. The exquisite details and precise motion system of the horse riding pump are the products of careful perfusion and are specially designed for highend design.

HIGOLD

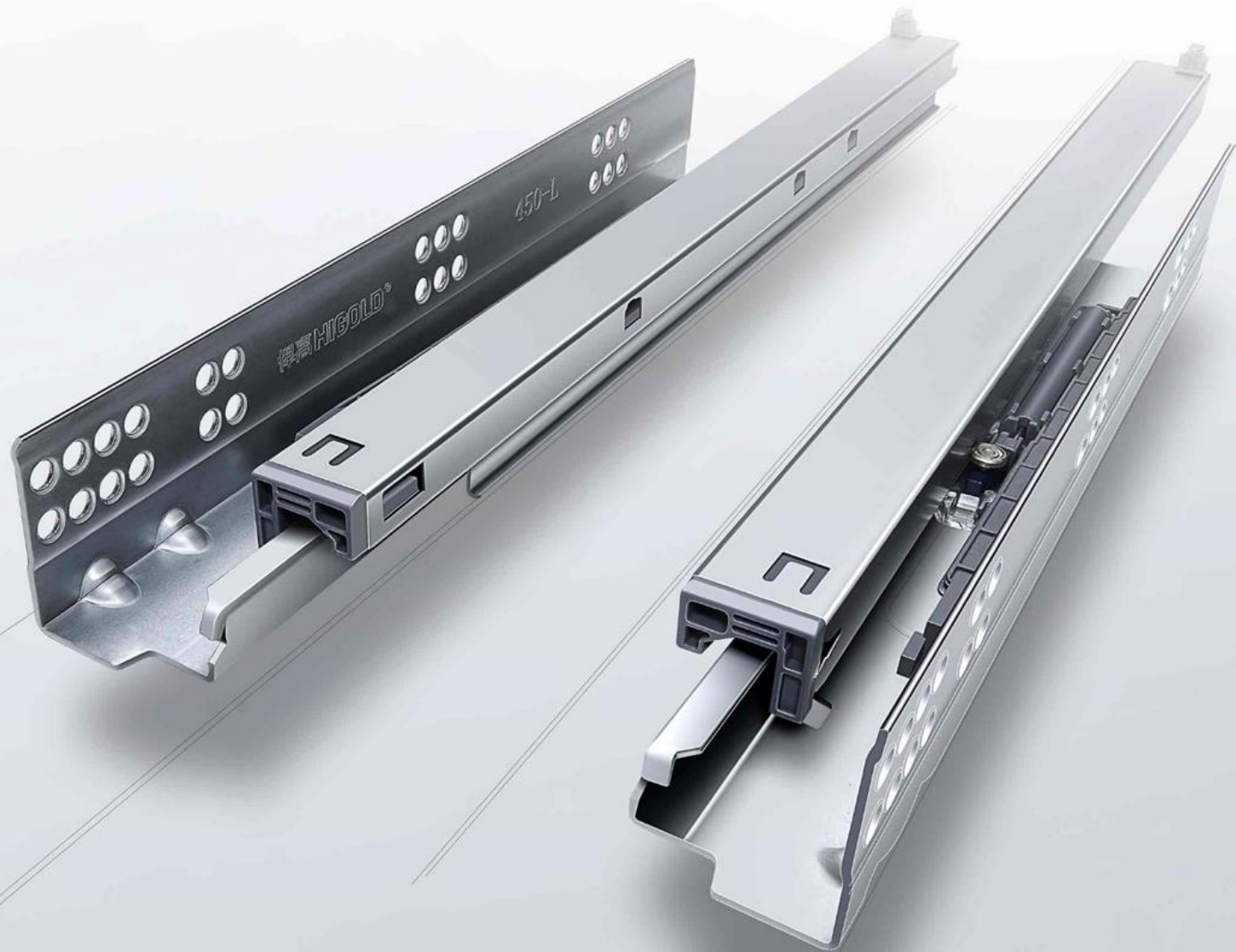











## G SERIES SLIDE

### G系列半拉出阻尼隐藏滑轨

看不见的滑轨，更美观的家。易拆卸，抽清洁更方便。L形插销拉出即可分离抽屉。清洁时可轻松将抽屉内的垃圾倒出。  
Invisible slide rail, more beautiful home, easy disassembly, drawer cleaning is more convenient, the drawer can be separated by pulling out the L-shaped latch, and the garbage in the drawer can be easily poured out when cleaning the drawer.



型号 (16板) ART. NO.	型号 (18板) ART. NO.	标称长度 NL	特性 FEATURES
811089C	811089NC	250mm	- 材质: 冷轧钢
811073C	811073NC	300mm	- 表面处理: 镀锌
811074C	811074NC	350mm	- 额定承重: 25kg
811075C	811075NC	400mm	- 使用寿命: 过 50000 次; 检测报告编号: SDH-L2105008535FT
811076C	811076NC	450mm	- 尺寸范围: 250-500mm, 也可根据要求定制
811077C	811077NC	500mm	- 安装方式: 隐藏安装 - 产品应用: 办公家具, 民用家具, 橱柜等

#### INSTALLATION INSTRUCTION | 安装示意图

##### 安装说明

W: 柜子内宽  
L: 抽屉长度  
NL: 产品标称长度  
DL: 柜子内部深度  
X: 面板厚度

W: Internal cabinet width  
L: Drawer length  
NL: Assembling dimensions length  
DL: Internal cabinet depth  
X: The drawer board thickness  
Unit:mm

##### 抽屉外置安装尺寸

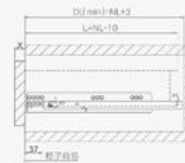

##### 抽屉内置安装尺寸

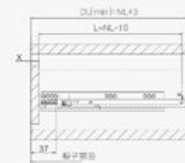

##### 滑轨孔位尺寸

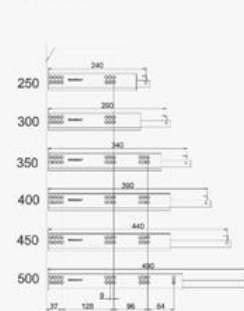

Unit:mm  
单位: 毫米

##### 滑轨安装尺寸

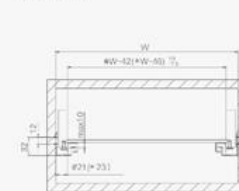

带 # 为板厚 16mm 滑轨安装尺寸 Unit:mm  
带 \* 为板厚 18mm 滑轨安装尺寸 单位: 毫米

##### 抽屉安装准备

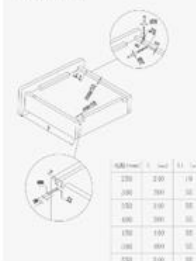

##### 安装螺丝要求

##### 平头螺丝 Countersunk screw

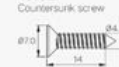

##### 欧标螺丝 Euro screw











G / SERIES

## G SERIES SLIDE

### G系列钢珠反弹三节轨

抽屉按压弹出，再按关闭。抽屉无需装拉手，更加美观，并避免了碰撞到凸出的拉手的烦恼。

Drawer press pop-up, then press close. The drawer need not install handle, more beautiful, and avoid bump bump into protruding handle trouble.



型号 (白色) ART. NO.	型号 (黑色) ART. NO.	标称长度 NL	特性 FEATURES
819401	819501	250mm	- 材质: 冷轧钢 - 材料厚度: 1.2x1.2x1.5mm
819402	819502	300mm	- 表面处理: 镀锌, 电泳处理
819403	819503	350mm	- 额定负重: 35kg (450mm 标称长度) - 使用寿命: 过 50000 次
819404	819504	400mm	- 尺寸范围: 250-500mm - 特殊功能: 稳定的缓冲结构, 缓冲行程达 55mm, 阻尼调节和锁功能
819405	819505	450mm	- 安装方式: 侧装安装
819406	819506	500mm	- 产品应用: 铁柜, 办公家具, 民用家具, 橱柜等

#### INSTALLATION INSTRUCTION | 安装示意图

安装孔距

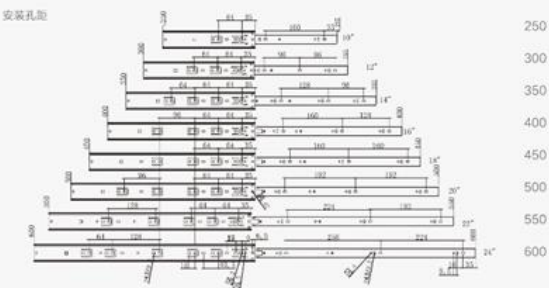

产品宽度

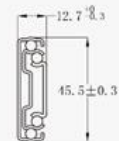

空间需求

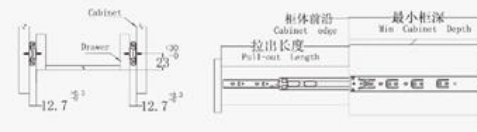

系列长度	250	300	350	400	450	500
抽屉长度 (mm)	250	300	350	400	450	500
最小柜深	255	305	355	405	455	505



## G SERIES BALL BEARING SLIDES

“高精度轨道珠沟，顺畅无声”

**HIGOLD® G系列静音三节轨**

功能久经验证，设计赏心悦目的弹高静音三节轨系列，凭借精湛的技术及稳定的功能深受用户好评。力求每一个用户打开抽屉都是静音稳定的。

It has the function of auto-closing and auto-reset, which can prevent the damping failure and reduce the failure rate. Through the LGA international certification body to carry out the test of 45KG heavy load products, the test life reaches 100,000 times which is more than 2 times longer than the ordinary products.











## N SERIES SLIDE

N系列薄款钢珠阻尼三节轨



型号 ART. NO.	标称长度 NL	特性 FEATURES
819911	250mm	
819912	300mm	· 材质: 冷轧钢
819913	350mm	· 材料厚度: 1.0x1.0x1.2mm · 表面处理: 电泳处理 · 额定负载: 25KG (450mm 标准长度)
819914	400mm	· 使用寿命: 过 50000 次 · 尺寸范围: 250-500mm, 也可根据要求定制
819915	450mm	· 安装方式: 侧装安装
819916	500mm	· 产品应用: 铁柜, 办公家具, 民用家具, 橱柜等

### INSTALLATION INSTRUCTION | 安装示意图

安装孔距

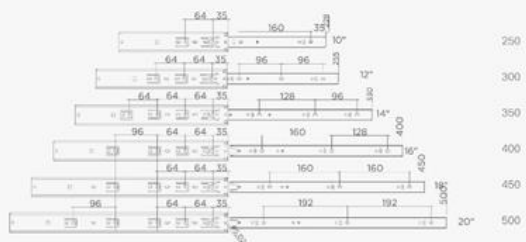

产品宽度

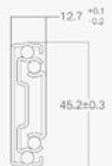

空间需求



系列长度	250	300	350	400	450	500
抽屉长度 (mm)	250	300	350	400	450	500
最小柜深	255	305	355	405	455	505

## N SERIES SLIDE

N系列薄款钢珠三节轨



型号 ART. NO.	标称长度 NL	特性 FEATURES
819711	250mm	
819712	300mm	· 材质: 冷轧钢
819713	350mm	· 材料厚度: 1.0x1.0x1.2mm · 表面处理: 电泳处理 · 额定负载: 25KG (450mm 标准长度)
819714	400mm	· 使用寿命: 过 50000 次 · 尺寸范围: 250-500mm, 也可根据要求定制
819715	450mm	· 安装方式: 侧装安装
819716	500mm	· 产品应用: 铁柜, 办公家具, 民用家具, 橱柜等

### INSTALLATION INSTRUCTION | 安装示意图

安装孔距



产品宽度

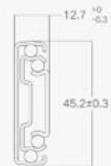

空间需求



系列长度	250	300	350	400	450	500
抽屉长度 (mm)	250	300	350	400	450	500
最小柜深	255	305	355	405	455	505



# M SERIES PROP SHAFT

M系列 · 上翻支撐





# LET AMBRY DESIGN MORE CLEVER

## M系列上翻支撑

M系列上翻支撑，按照人体工程学设计，颠覆旧有柜门开启理念，开合均可带有阻尼，轻盈舒适，根据实际情况可以单边或者双边安装，让开启方式有一种未来的感觉。

M-Series upturn support, according to ergonomic design, subvert the old concept of cabinet door opening, opening and closing can be with damping, light and comfortable, according to the actual unilateral or bilateral installation, let open way have a feeling of the future.







G系列·上翻支撑

# G SERIES PROP SHAFT











G / SERIES

## G SERIES LIFT SYSTEM

G系列简约 - 缓冲款上翻门气撑

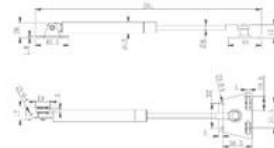

型号 ART.NO.	标称长度 NL	支撑力 / 门板重量 WEIGHT	门高 HIGH	柜体深度 DEPTH	所需产品 PRODUCT	产品说明 DESCRIPTION	特性 FEATURES
817001C	10寸	3kg / 80N	≥300mm	≥300mm	1套	<ul style="list-style-type: none"> <li>- 20# 精轧管</li> <li>- 表面钝化、喷漆</li> </ul>	<ul style="list-style-type: none"> <li>- 采用轻钢，适宜产品等磁矩</li> <li>- 轻松开启</li> <li>- 力保承载柜内物品</li> <li>- 应用范围广</li> <li>- 安装简单，调节方便</li> <li>- 静音气撑，金属保命器</li> <li>- 使用寿命长</li> <li>- 可 30° - 90° 内随意停放</li> </ul>

INSTALLATION INSTRUCTION | 安装示意 817002/817003/817004

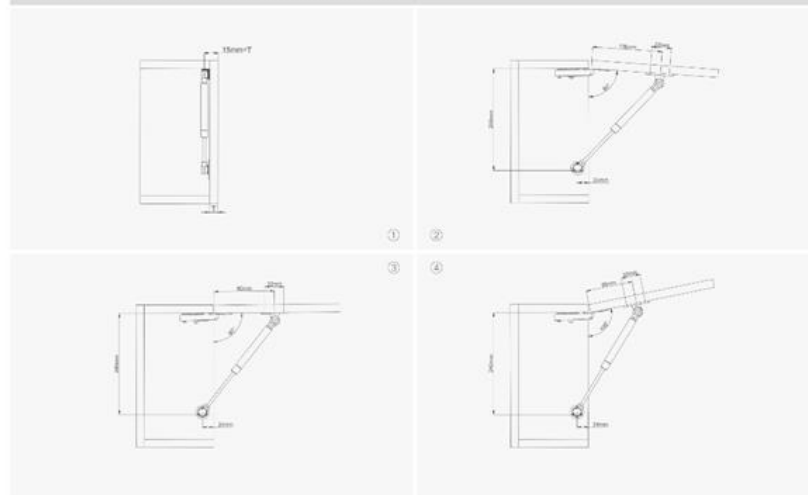







## G SERIES SUSPENSION BRACKET

G系列 - 明装合金吊码



型号 ART. NO.	颜色 COLOUR	承重 WEIGHT	调节功能 FUNCTION	材质 MATERIAL	表面处理 SURFACE	特性 FEATURES
838009	白色	130kg/对	深度 20mm 高度 7mm	冷轧钢	镀锌	- 锌合金主体, 更强承重 - 纤薄外观, 提升档次
838014	黑色			铝合金		PS 塑料

## INSTALLATION INSTRUCTION | 安装示意图

定位



开孔及安装

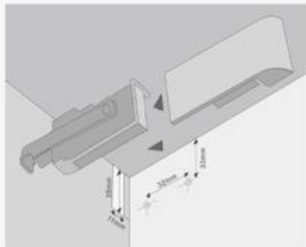

挂轨

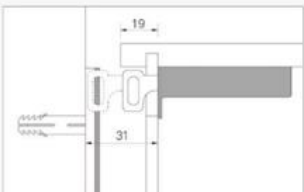

挂钩

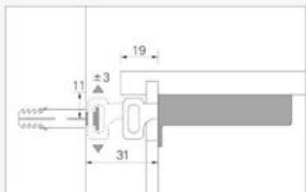

## G SERIES SUSPENSION BRACKET

G系列 - 明装防脱吊码



型号 ART. NO.	颜色 COLOUR	承重 WEIGHT	调节功能 FUNCTION	材质 MATERIAL	表面处理 SURFACE	特性 FEATURES
838010	白色	100kg/对	深度 30mm 高度 9mm	冷轧钢	镀锌	- ABS 主体, 抗氧化更耐用 - 两种颜色, 适配不同家装
838015	黑色			ABS 塑料		镀锌

## INSTALLATION INSTRUCTION | 安装示意图

定位



开孔及安装

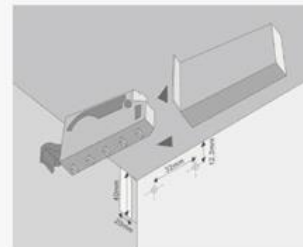

挂轨

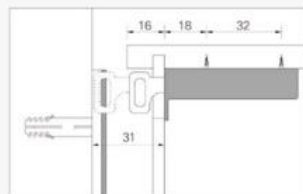

挂钩

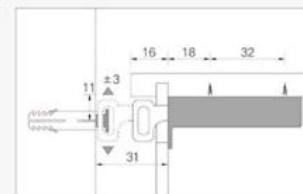







G / SERIES

## G SERIES SUSPENSION BRACKET

G系列 - 暗装吊码



型号 ART.NO.	颜色 COLOUR	承重 WEIGHT	调节功能 FUNCTION	材质 MATERIAL	表面处理 SURFACE	特性 FEATURES
B39012	不锈钢色	140kg/对	深度 10mm 高度 ±9mm	铁 锌合金	蓝锌	<ul style="list-style-type: none"> <li>- 冷轧加工体，更结实</li> <li>- 隐藏式安装，不占柜内空间</li> <li>- 双滚调节功能，轻松便捷</li> </ul>

### INSTALLATION INSTRUCTION | 安装示意图

